

## Typical electric panel heater layout

PRE2000CU3 PRE2000PU3 PRE6000 Energy Lock panel heater

Layout diagram page 1 of 1



Cleverly simple  
control of energy.

When using Prefect Irus an Atlantic Prefect Energy Lock heater must be used.

Position the PRE2000PU3 close to the heater that it is to control. Mount in a 25mm or deeper two gang flush or surface box.

A PRE6000 double pole key switch must be used providing tamper-proof double pole isolation.

The PRE2000CU3 should be mounted at least 300mm away from the nearest edge of heater, do not mount the CU3 above the heater. Mount the CU3 where it is protected from artificial heat sources for example: Desktop computers, TV's, Desk lamps etc.

Do not mount close to forced ventilation.

The PRE2000CU3 is equipped with a PIR for presence detection, be sure to mount the PRE2000CU3 in such a position to provide a clear view of the required detection area, the maximum detection range is 5m.

The Thermostat should be mounted between 1200mm and 1400mm from finished floor level. Mount in a 25mm or greater single gang flush or surface box. If mounting in a flush metal box the top and bottom box lugs must be removed.

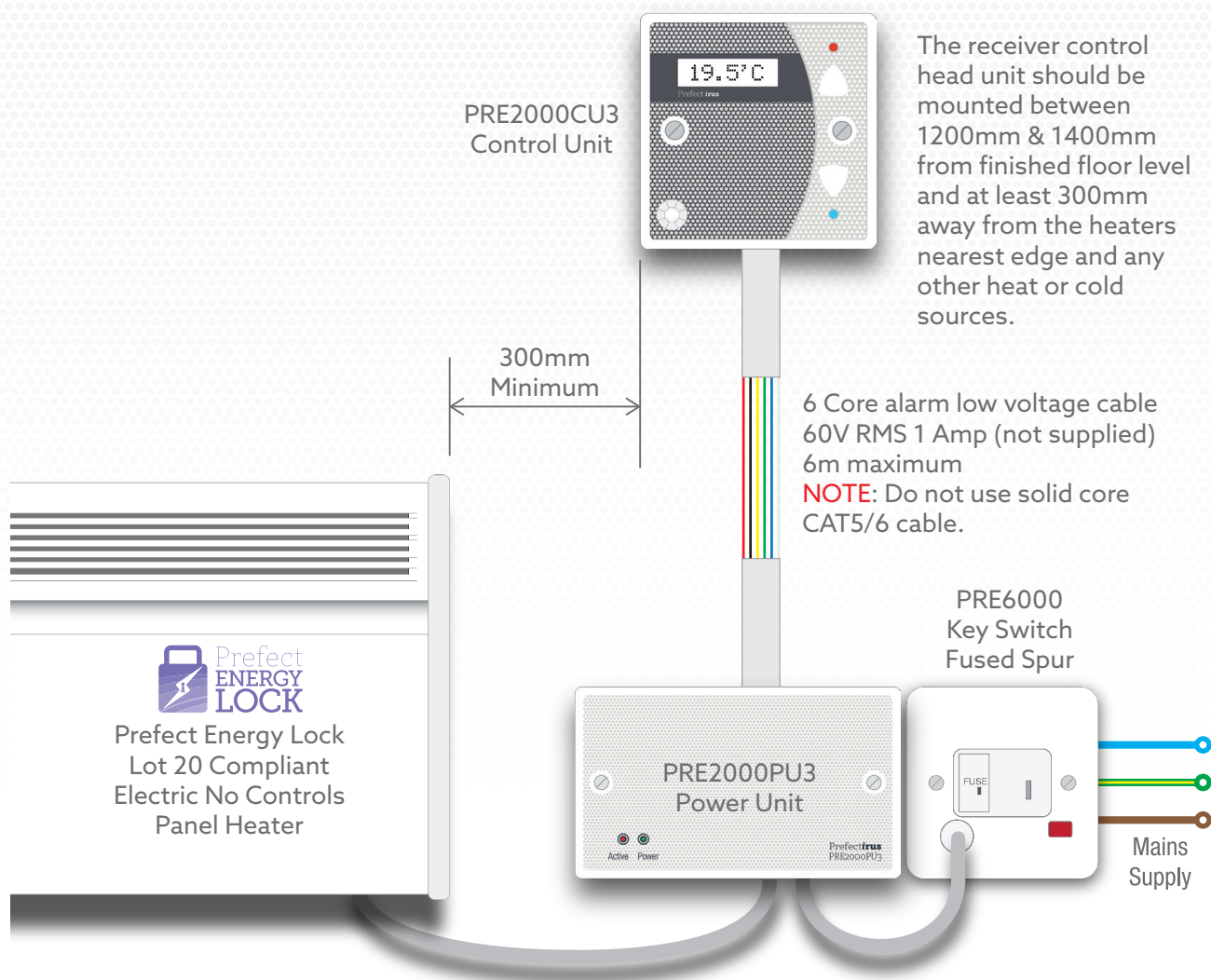

V1 02/05/19 WD-140

Due to our policy of continuous improvement, we reserve the right to change specifications without notice. All information was correct at time of when this product file was produced - September 2020