

# PRE3201 - AD

Instructions - page 1 of 9

Ceiling mounted PIR



Cleverly simple  
control of energy.



## DESCRIPTION AND OPERATION

The PRE3201-AD PIR (passive infrared) presence detector provides automatic control of lighting loads with optional manual control.

The output channel comprises a mains voltage relay capable of simple on/off switching.

Functioning as a presence detector, the unit can turn lights on when a room is occupied and off when the room is empty. Optional settings allow lights to be turned off in response to ambient daylight.

All functionality is fully programmable using an IR handset.

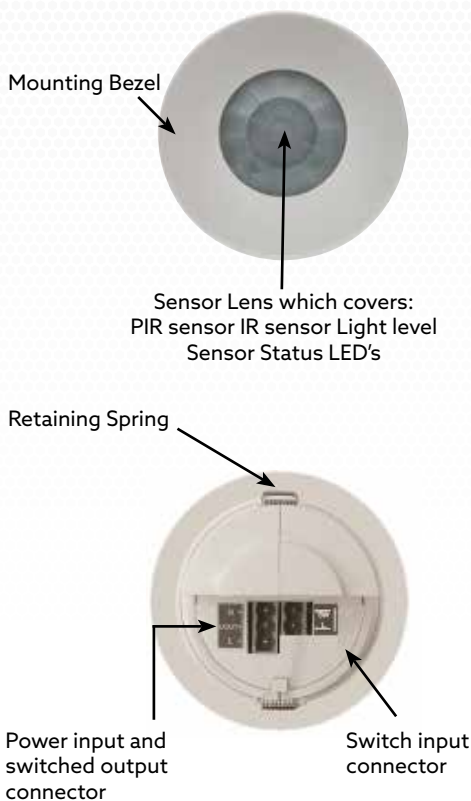

## FEATURES

**PIR Sensor** - Detects movement within the unit's detection range, allowing load control in response to changes in occupancy.

**IR Receiver** - Receives control and programming commands from an IR (infrared) handset.

**Light level sensor** - Measures the overall light level in the detection area.

**Status LED's** - The LED flashes red to indicate the following:

**Walk Test LED active**  when movement is detected

**Valid setting received** 

**Power input & Switched output connector (channel 1)** - Used to connect mains power to the unit and to connect a switched load.

**Switch input connector** - Two input terminals can be used to manually override the dimming levels and override the lights on and off.

Due to our policy of continuous improvement, we reserve the right to change specifications without notice.  
All information was correct at time of when this product file was produced - April 2020



Cleverly simple  
control of energy.

## DETECTION PATTERN

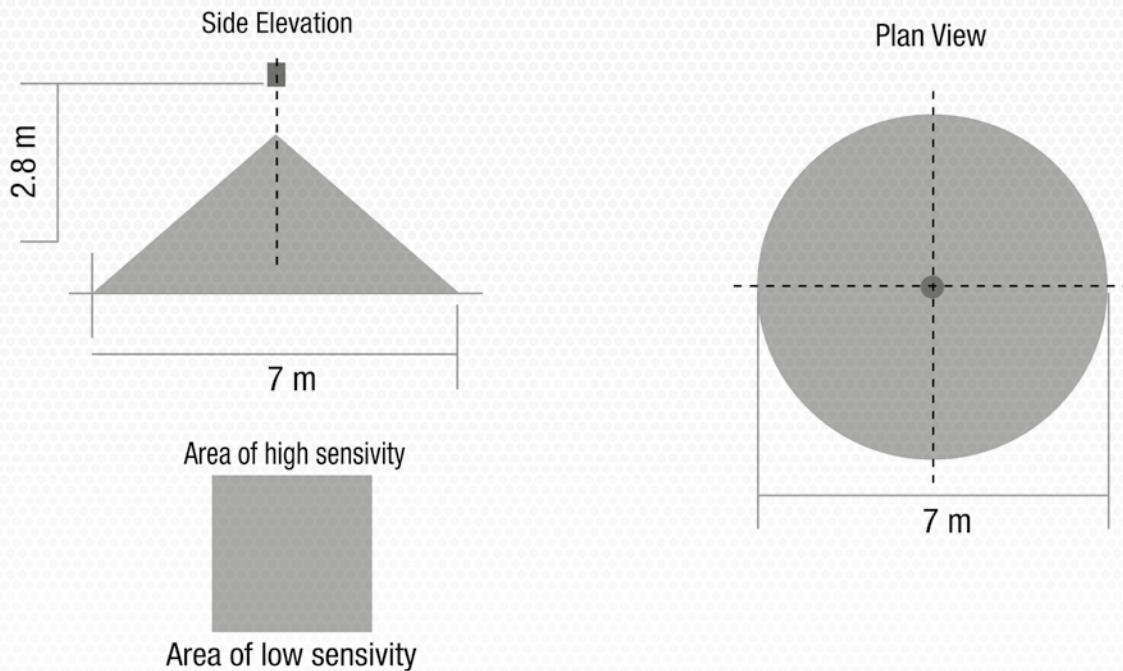

## SENSOR FUNCTIONALITY

**Detection Mode.** The Detection Mode can be set to behave in Presence or Absence mode:

- **Presence** - When movement is detected the load will automatically turn on. When the area is no longer occupied the load will automatically switch off after an adjustable time period.
- **Absence** - The load is manually switched on. When the area is no longer occupied the load will automatically switch off after the adjustable time period has elapsed.

In either case, sensitivity to movement of the PIR sensor can be adjusted using the Sensitivity parameter.

**HINT:** To assist in setting the Sensitivity, turn on the Walk Test LED which will flash red when movement is detected

**Switch Level On/Off.** Occupancy detection can be made dependant on the ambient light level using the lux on level and lux off level parameters.

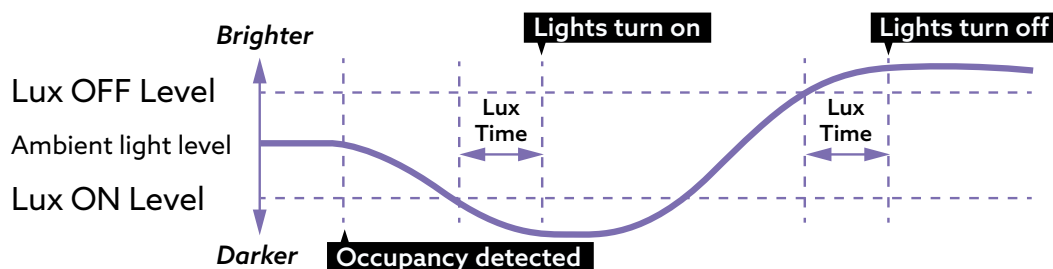

Due to our policy of continuous improvement, we reserve the right to change specifications without notice.  
All information was correct at time of when this product file was produced - April 2020

# PRE3201 - AD

Instructions - page 3 of 9

Ceiling mounted PIR



Cleverly simple  
control of energy.

## INSTALLATION

### Choosing a Suitable Location

The PRE3201-AD is designed to be ceiling mounted and must satisfy the following criteria:

- Avoid positioning the unit where direct sunlight may enter the sensor element.
- Do not site the sensor within 1m of any lighting, forced air heating or ventilation.
- Do not fix the sensor to an unstable or vibrating surface.

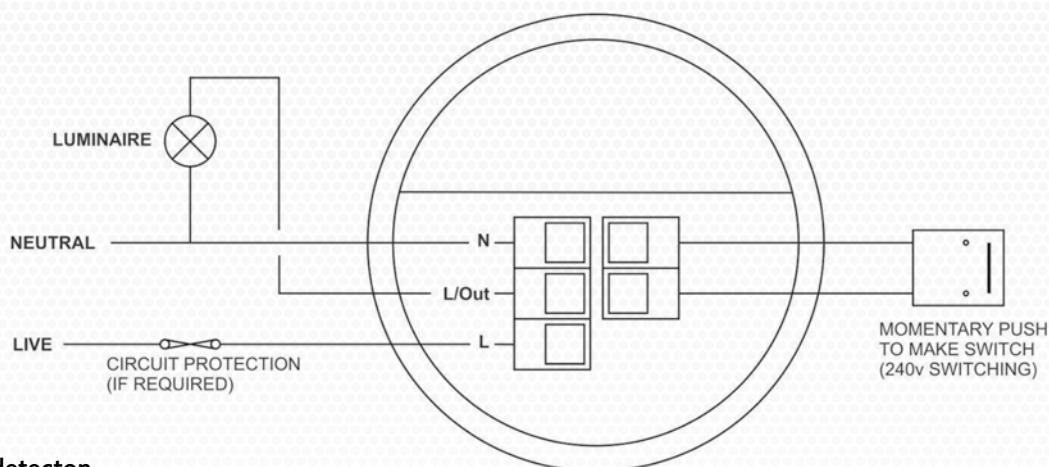

### Absence detection

- To use absence detection a retractive (momentary) switch must be connected between the 2 terminals on the diagram. Note that this will be switching mains voltage.
- The unit ships with presence detection as default. To change to absence detection, press and release the external switch 5 times within the first minute of power up. The LED will turn on solid for 30 seconds to indicate absence mode has been selected.
- To change back to presence detection, repeat the above procedure—the LED will flash for 30 seconds to indicate presence mode has been selected.

**Note:** the above adjustments can also be made using the PRE5901-2 or PRE5900 handsets.  
See Programming sections.

## POWER-UP TEST PROCEDURE

When power is applied to the unit, the load will turn on immediately.

Set the timeout to 10 seconds, vacate the room or remain very still and wait for the load to switch off. Check that the load switches on when movement is detected.

The unit is now ready for programming.

Due to our policy of continuous improvement, we reserve the right to change specifications without notice.  
All information was correct at time of when this product file was produced - April 2020

# PRE3201 - AD

Instructions - page 4 of 9

Ceiling mounted PIR



Cleverly simple  
control of energy.

## INSTALLATION

The PRE3201-AD is designed to be ceiling mounted:

### • Flush fixing

Warning - be careful bending springs when mounting unit.

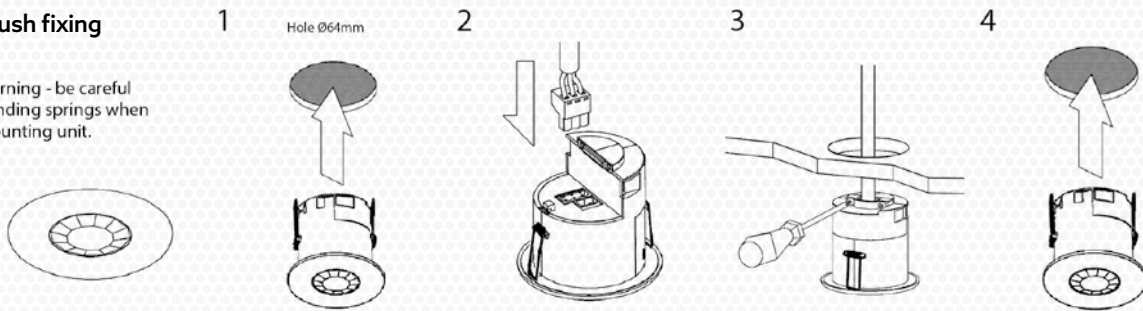

### • Surface fixing, using the optional surface mounting box (part no. PRE3BB).

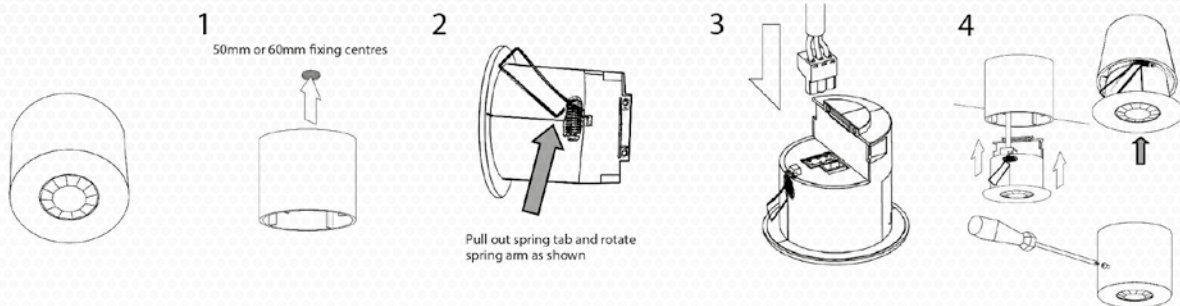

## WIRE STRIPPING DETAILS

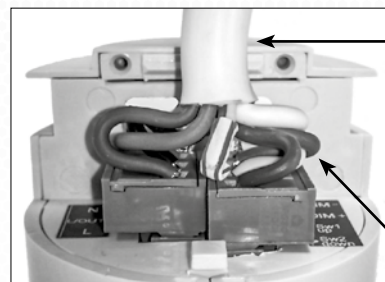
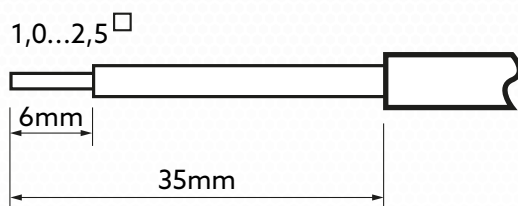

**Important**  
Ensure that the cables are formed as shown before fixing the cable clamp. The clamp **MUST** clamp the outer sheath only.

Bend cores as shown

Due to our policy of continuous improvement, we reserve the right to change specifications without notice. All information was correct at time of when this product file was produced - April 2020



Cleverly simple  
control of energy.

## READ BACK FUNCTION (PRE5900L HANDSET ONLY)

The PRE5900 has the ability to read back the settings stored in a device.

### To readback individual parameters

- Navigate to the parameter and press the "R" (Read) button whilst pointing the handset at the device. The handset will click when the parameter has been readback, the device will flash it's LED, and the value will be shown against the parameter in the menu.

### To read back all of the parameters in a menu

- Press and hold the "R" (Read) Button for more than 1 second.
- The handset will click every time a parameter is received.
- The device will show multiple flashes of it's LED.
- All of the values will be shown against the parameters in the menu.
- The individual parameters may be edited and then saved as a "macro".

### Notes

- If a parameter(s) has been missed because of a communication error, the missing value(s) is replaced by dashes.
- When reading back, the channel 1 relay (where fitted) will temporarily be switched of, and will return to it's normal state 2 seconds after the readback has been completed.

# PRE3201 - AD

Instructions - page 6 of 9

Ceiling mounted PIR



Cleverly simple control of energy.

## BASIC PROGRAMMING

The functionality of the PRE3201-AD is controlled by a number of parameters which can be changed or programmed by any of the following devices:

- PRE5901-2 Infrared Handset. See below for programmable functions.
- PRE5900 Infrared Handset (with LCD). See user guide for full programming details.

For most basic programming operations the PRE5901-2 handset can be used and the following procedures are based on using this device.

Point the handset at the Sensor and send the required programming commands to the unit as shown right.

Valid commands will be indicated by a red LED flash. See page 1 for details of other LED responses.

**Note:** other functions on the PRE5901-2 which are not shown below are not applicable to this product.

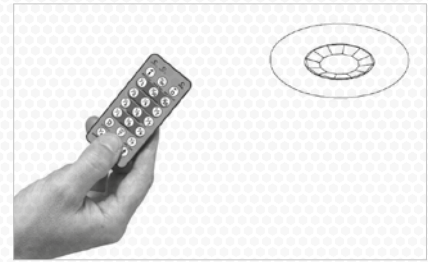

Parameter name	Default value	Number of shift key presses				UHS5 Handset Graphics	Description
		0 Shift 1 Shift 2	1 Shift 1 Shift 2	2 Shift 1 Shift 2	3 Shift 1 Shift 2		
On		On					Turn lights on.
Off		Off					Turn lights off.
Walk test	Off	On	Off				When set to On, this causes a red LED to flash, on the sensor, when it detects movement. Use this feature to check for adequate sensitivity levels.
Time Out (Time adjustment)	20 minutes	1, 10 & 20 minutes	5, 15, & 30 minutes	10 seconds			Once the detector is turned on, this value sets how long the lights will stay on once movement has ceased.
Lux on level (Switch level on)	9	2, 5 & 7	4, 6 & 9				Lux level setting to prevent the luminaires being switched on if the ambient light level is sufficient (adjustable between 1 and 9). The luminaires will always be switched on at level 9.
Lux off level (Switch level off)	9	2, 5 & 7	4, 6 & 9				Lux level setting to switch the luminaires off during occupancy if the ambient light level goes above the setting (adjustable between 1 and 9). Level 9 will always keep the lights on. This setting can be used for "window row setting".*
Sensitivity	9	1, 5 & 9	3, 6 & 8				Sensitivity for detecting movement. 1 = low sensitivity 9 = high sensitivity.
Defaults				D			Returns the unit to the default settings.
Presence/Absence	Presence	Presence	Absence				Presence mode allows the output to turn on when movement is detected and off when movement ceases. Absence mode allows the output to turn off when movement ceases, but must be manually turned on first.
Shift							Use this button to select the settings in red and blue signified by the 'Shift 1' and 'Shift 2' LEDs.

\* NOTE: The Lux Off Level value must always be greater than the Lux On Level value.

Due to our policy of continuous improvement, we reserve the right to change specifications without notice. All information was correct at time of when this product file was produced - April 2020

# PRE3201 - AD

## Instructions - page 7 of 9

### Ceiling mounted PIR



Cleverly simple  
control of energy.

## FAULT FINDING

### What if the load does not turn ON?

- Check that the live supply to the circuit is good.

- If the detection range is smaller than expected, check the diagram on page 2. Rotating the sensor slightly may improve the detection range.

HINT: The Walk Test LED function can be used to check that the unit is detecting movement in the required area.

### What if the load does not turn OFF?

- Ensure that the area is left unoccupied for longer than the Time Out Period.
- Ensure that the sensor is not adjacent to circulating air, heaters or lamps.

## ADVANCED PROGRAMMING

Parameter Name	Default Value	Range / Options	Description	5901-2	PRE5900
<b>Detector Parameters</b>					
Walk Test LED	Off	On or Off	When set to On this causes a red LED to flash, on the sensor, when it detects movement. Use this feature to check for adequate sensitivity levels.	✓	✓
Time Out (Time adjustment)	20 minutes	0-99 minutes	Once the detector is turned on, this value sets how long the lights will stay on once movement has ceased. Select 0 for 10 second delay - use for commissioning only.	✓	✓
Manual Time Out	10 minutes	0-99 minutes	When a manual operation occurs, either via the switch input or the infrared, it invokes the timeout period.  Example 1: a detector in presence mode has a detector timeout of 15 minutes and a manual timeout of 3 minutes. When the user leaves the room they press the off button. The sensor will revert to automatic after 3 minutes, and then walking back in the room will turn the lights on.  Example 2: using the settings above, the user turns the lights off (say for a presentation) but stays in the room. Every time a movement is detected, the manual timeout period is re-triggered, but when it doesn't pick up for the short timeout period, the sensor will timeout and revert to automatic. This means the lights may turn on inadvertently during the presentation, if the occupants are still for the manual timeout period, so adjust the timing carefully.	✗	✓
Sensitivity On	9	1 (min) to 9 (max)	Sensitivity level for detecting movement when the detector is already on. *PRE5901-2 sets Sensitivity On and Off to the same value.	✓*	✓
Sensitivity Off	9	1 (min) to 9 (max)	Sensitivity level for detecting movement when the detector is off. *PRE5901-2 sets Sensitivity On and Off to the same value .	✓*	✓
Lux time	0	0 (disabled) 1-99 minutes	If the detector measures the lux level and decides that the output needs switching on or off as a consequence, the lux time must elapse first. If at any time during the timed delay the lux change reverses then the process is cancelled. Lux Time enables absence detection to be implemented with a lux off level set. When the button is pressed, the lights will go on, regardless of ambient light level. However, if there is sufficient ambient light, they will turn off again after the Lux Time. <i>Note that whenever an external switch is pressed, whether in absence or presence mode, if the lights were out because of the lux level, they will be immediately turn on again for at least the Lux Time.</i>	✗	✓
Power Up State	On	On or Off	Select No for a 30 second delay on start up. If Yes is selected, there will be no delay on start up and the detector will always power up detecting.	✗	✓
Inhibit	4 seconds	1 to 999 seconds	When the detector turns off, a delay is instigated to prevent retriggering. In certain circumstances this delay may not be enough. This parameter allows the delay to be changed.	✗	✓
Factory default	-	-	Restores factory default settings	✓	✓

Due to our policy of continuous improvement, we reserve the right to change specifications without notice. All information was correct at time of when this product file was produced - April 2020

# PRE3201 - AD

## Instructions - page 8 of 9

### Ceiling mounted PIR



Cleverly simple  
control of energy.

#### Switching functions

Detection Mode	Presence	Presence or Absence	Presence mode allows the output to turn on when movement is detected and off when movement ceases. Absence mode allows the output to turn off when movement ceases, but must be manually turned on first.	✓	✓
Lux on level (Switch level on)	9	1-9 For a higher resolution a scale of 101-199 is available	Sets a minimum light level below which the PIR sensor is enabled, allowing lights to be turned on by movement. <i>Note: the Lux Level Off value must always be greater than the Lux Level On value.</i>	✓	✓
Lux on level (Switch level off)	9	1-9 For a higher resolution a scale of 101-199 is available	Sets a maximum light level above which the PIR sensor is disabled, preventing lights from being turned on by movement.	✓	✓

#### User Modes

Override On	-	-	If the lights are off, sending the IR command will turn them on immediately and revert to automatic operation using the manual timeout period.	✓	✓
Override Off	-	-	If the lights are on, sending the IR command will turn them off immediately. After the manual timeout period (described above), the sensor will revert to automatic.	✓	✓
Cancel	-	-	Cancels the on or off override, returning the detector to normal operation.	✗	✓

#### Switching Input Modes

1 position switch together	Default	-	Short press on, short press off.	✗	✓
2 position switch together		-	Short press on, long press off.	✗	✓

Due to our policy of continuous improvement, we reserve the right to change specifications without notice. All information was correct at time of when this product file was produced - April 2020

# PRE3201 - AD

Instructions - page 9 of 9

Ceiling mounted PIR



Cleverly simple  
control of energy.

## TECHNICAL DATA

Dimensions	See diagram opposite
Weight	0.15 KG
Supply Voltage	230VAC +/- 10%
Frequency	50Hz
Maximum Load	10A of lighting and/or ventilation Including incandescent, fluorescent, compact fluorescent, low voltage (by switching the primary of transformer)
Power consumption	On 875mW, Off 895mW
Terminal capacity	2.5mm <sup>2</sup>
Temperature	- 10°C to 35°C
Humidity	5 to 95% non-condensing
Material (casing)	Flame retardant ABS and PC/ABS
Type	Class 2
IP rating	IP40
Compliance	EMC-2004/108/EC LVD-2006/95/EC

PRE3201-AD

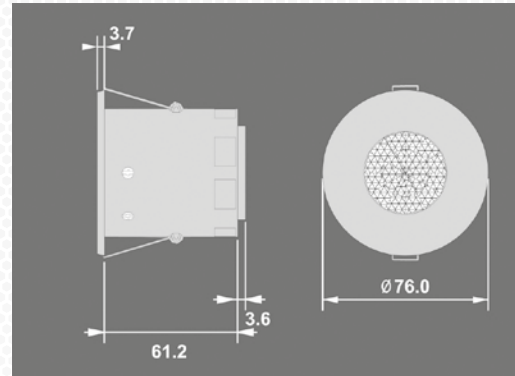

PRE3BB

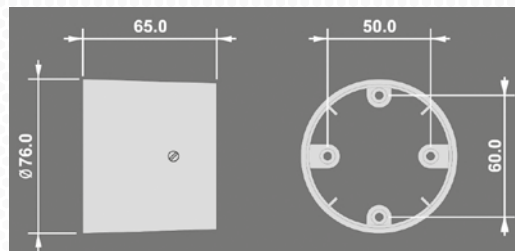

## PART NUMBERS

	Part number	Description
Detector	PRE3201-AD	Ceiling PIR presence detector
Accessories	PRE3BB	Surface mounting box
	PRE5901-2	Programming IR handset
	PRE5900L	Universal LCD IR handset

### IMPORTANT NOTICE

This device should be installed by a qualified electrician in accordance with the latest edition of the IEE Wiring Regulations and any applicable Building Regulations.



Due to our policy of continuous improvement, we reserve the right to change specifications without notice.  
All information was correct at time of when this product file was produced - April 2020

Prefect Controls Limited, Unit 2, Church Field Business Park, Church Field Road, Sudbury CO10 2YF  
01787 320604 | mail@prefectcontrols.com | prefectcontrols.com

10180