

Hobsafe PRE9277

Instructions - page 1 of 2

9.2kW 40A 2 gang hob run timer



Cleverly simple
control of energy.



PRE9277 Hobsafe Dimensions

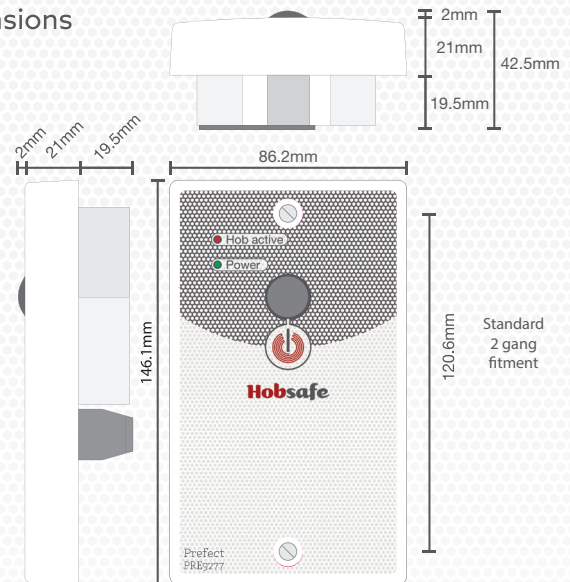

SPECIFICATION

Size - Standard 2 gang plate size. Requires a 45mm or deeper 2 gang surface or flush box. When mounting into a flush wall box or metal clad box remove any unused mounting lugs of the box.

Supply voltage - 230V AC at 50Hz.

Load - 40A Resistive.

Electrical connections - Live in (LIVE), 2x Neutral (N), Switched Live out (LOAD)

Terminal capacity - 0.6mm² Minimum, 13.3mm² Maximum.

Indicators - Power (Green), Active (Red)

Adjustments - Run time and program adjustment via DIP switches.

Programs - Fixed or ON-OFF mode

Timing range - 15, 20, 30 or 45 Minutes

Conformance - EN60730

Casing material - PC/ABS

Time accuracy - $\pm 2\%$

Note: Power factor correction capacitor PRE9277

If the hob timer is used to switch small loads such as a contactor coil it may be necessary to fit a power factor correction capacitor between the Live in and Neutral of the contactor coil. Prefect Part Number PRE-PCFC01

CARE AND MAINTENANCE:

Before undertaking any maintenance and or care work, ensure the timer's electrical supply is fully isolated.

Cleaning - Use a clean cloth and a mild detergent to clean and degrease the timer. Only use a minimal amount of cleaning fluids, apply only to a soft cloth do not apply directly to the timer.

Maintenance - Electrical maintenance work should only be attempted by a competent person. The units settings can be altered after installation. The units settings may be altered while the unit is wired and safely isolated.

PLEASE NOTE: This Prefect product is designed to limit the time the hob is powered on. It does not detect fire or alert if a pan fire occurs, therefore this product does not comply with EN 50615.

Due to our policy of continuous improvement, we reserve the right to change specifications without notice. All information was correct at time of when this product file was produced - April 2020



Cleverly simple
control of energy.

SETTINGS

All settings for the PRE9277 timer are set via the DIP switches located on the upper right hand side on the rear of the timer. Note that there are 3 numbered DIP switches. Each DIP switch can be either on or off.

Two modes are available, "ON/OFF" or "FIXED" mode. When set to "FIXED" mode, a button press will start the run time. The unit will continue until the run time has expired and switches off. In the final 60 seconds of an active run time the Hob active LED will begin to flash, this means the current run time is about to expire. During this final 60 seconds the button can be pressed to restart the run time for a further duration if required. If the button is not pressed the unit will switch off. The unit can only be started when off or during the final 60 seconds of a run time, pressing the button at any other time will have no effect.

A ticked DIP switch indicates the switch is in the ON position									
Program		Run Time (Minutes)							
Fixed	ON/OFF	15	20	30	45				
Switch Number & Position									
1	1	2	3	2	3	2	3	2	3
ON	OFF	ON	ON	ON	OFF	OFF	ON	OFF	OFF

When set to "ON/OFF" mode, the unit will start the set run time when the button is pressed. If during the run time the button is pressed again, the run time will be cancelled and the unit will switch off. If the button is then pressed again a new run time will start.

Nearing the end of a run time the Hob active LED will begin to flash, this indicates the current run time is about to expire.

INSTALLATION

- All installation and wiring works must be completed by a competent person.
 - Locate the timer at a minimum distance of 300mm away from the nearest edge of the Hob. Ensure the timer is installed in such a position that it can be safely operated while the hob is in use.
NOTE: The timer is not water-proof. Mount the timer at a safe distance from any liquid sources.
 - Ensure the timer has a local means of safe isolation.
 - The timer can be mounted in both surface and flush boxes. When mounting into a metal clad back box or flush box ensure any unused lugs are removed.
 - Time and program switches should be set before installation into the accessory box .
1. Safely isolate the mains supply to the circuit that the timer is to be installed onto.
 2. Terminate the C.P.C to the earthing lug on the accessory box.
 3. Terminate the Live and Neutral supply from the isolator to the Live (LIVE) and Neutral (N) terminals of the timer.
 4. Terminate the hob supply Neutral to the second Neutral (N) terminal. Connect the hob Live supply to the Load (LOAD) terminal.

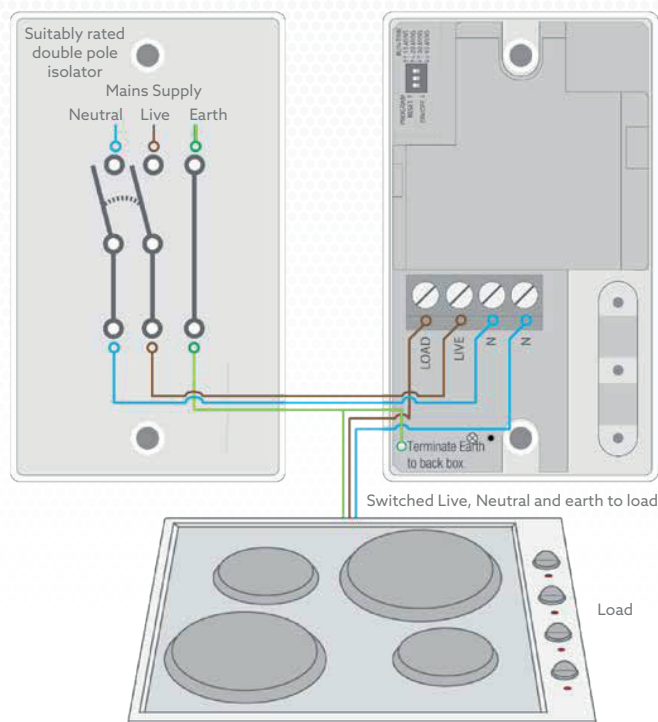

5. Ensure all cabling is correctly terminated.
6. Affix the timer to the accessory box. Take care not to damage either the cabling or the timer while tightening the fascia screws. Do not over-tighten the fascia.

Due to our policy of continuous improvement, we reserve the right to change specifications without notice. All information was correct at time of when this product file was produced - April 2020